

# YORK TOWNSHIP SECTION 24 R 14 TWP 14 MORGAN COUNTY, OHIO

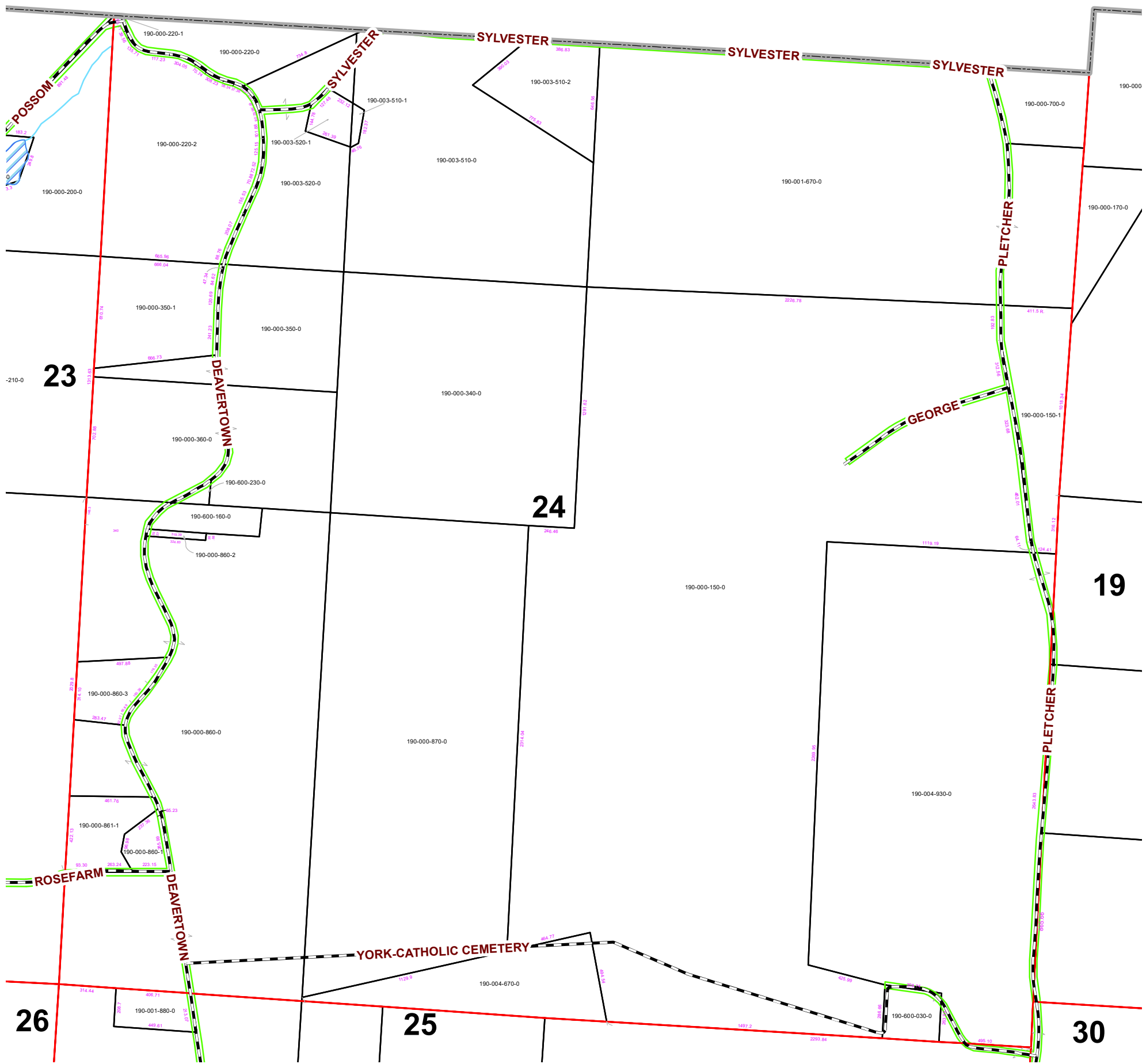

PIN	Owner	LegalDescr	Acres	VOL	PAGE	Survey_Ref
190-000-220-2	AMOS MICHAEL L	R14 T14 S24 SD 30	19.537	OR 231	3954	YRK-0320.pdf
190-600-230-0	BLACKOAK CEMETERY ASSO	R14 T14 S24 LOT 21	0.34	OR K	567	https://onedrive
190-000-220-0	BROMLEY J ROBERT TRUSTE	R14 T14 S24 SD 13	6.003	OR229	525	YRK-0318.pdf
190-600-030-0	CEMETERY (CATHOLIC)	R14 T14 S24 LOT 15	2			https://onedrive
190-000-150-1	CHERRY LLC	R14 T14 S24 SD 24	8.219	OR211	2699	YRK-0150.pdf
190-000-700-0	CHERRY WALTER M TRUSTEE	R14 T14 S24 SD 1 EX C	4.25	OR178	116	https://onedrive
190-600-160-0	CHURCH (U B )	R14 T14 S24 LOT 8	1	OR40	507	https://onedrive
190-000-870-0	CLUTTER LARRY A, GERALD	R14 T14 S24 SD 9 EX C	64.75	OR195	214	https://onedrive
190-000-860-0	CLUTTER LARRY A, GERALD	R14 T14 S24 SD 8	71.1	OR195	214	https://onedrive
190-000-860-1	CLUTTER LARRY TOD-SHERY	R14 T14 S24 SD 25	1.542	OR69	149	YRK-0312.pdf
190-000-860-3	COREY R & KRISTINE M ABRA	R14 T14 S24 SD 31 SUR	3	OR227	268	YRK-0313.pdf
190-001-670-0	FISHER RICHARD D & KAREN	R14 T14 S24 SD 2 SUR	75.75	OR183	457	https://onedrive
190-000-861-1	LARRY A & GERALD B CLUTT	R14 T14 S24 SD 32	3.457	OR227	881	YRK-0312.pdf
190-003-510-2	MCNEAL JASON	R14 T14 S24 SD 27	6.18	OR123	134	YRK-0214.pdf
190-003-510-1	MCNEAL RANDY & MARY	R14 T14 S24 SD 22 SUR	0.18	OR213	3468	YRK-0134.pdf
190-003-520-1	MCNEAL RANDY D & MARY	R14 T14 S24 SD 23 SUR	1.35	OR213	3468	YRK-0134.pdf
190-003-520-0	MCNEAL RUSSELL E & RAND	R14 T14 S24 SD 14 SUR	8.65	OR213	3468	https://onedrive
190-003-510-0	MCNEAL RUSSELL E & RAND	R14 T14 S24 SD 4 SUR	33.64	OR213	3468	https://onedrive
190-000-360-0	PENROD PENNY & LARRY J	R14 T14 S24 SD 7 SUR	19.66	OR225	3175	https://onedrive
190-000-340-0	PENROD PENNY & LARRY J	R14 T14 S24 SD 5 EX C	40	OR225	3175	https://onedrive
190-000-350-0	PENROD PENNY & LARRY J	R14 T14 S24 SD 6 EX C	11.72	OR225	3175	https://onedrive
190-000-350-1	PENROD PENNY P & LARRY J	R14 T14 S24 SD 26 EX	8.28	OR225	3175	YRK-0183.pdf
190-004-930-0	STONEBURNER SEAN ALAN	R14 T14 S24 SD 12 EX	69.557	OR162	229	YRK-0293.pdf
190-000-860-2	TRUSTEES OF BLACK OAK EN	R14 T14 S24 SD 29	0.29	OR156	543	YRK-0230.pdf
190-004-670-0	VANHORN ETHAN T & TORI	R14 T14 S24 SD 16-17	9.281	OR226	2988	YRK-0100.pdf
190-000-150-0	WATKINS ALVA C & DOROTH	R14 T14 S24 SD 3 SUR	168.84	OR146	115	YRK-0160.pdf

Source: Morgan County Engineer's Office  
 Author: Marcia Wolfe  
 Date: 02/10/20

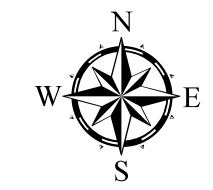
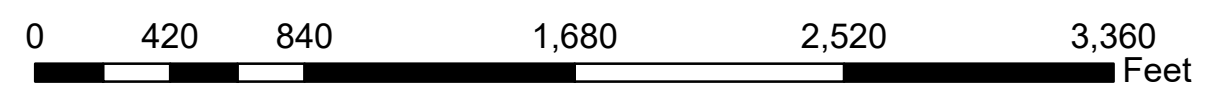

Boundaries			
	Hydro		Section
	Roads		Lot
	County		Township
	Parcel		ROW

Disclaimer: The information that these maps contains is for reference purposes only. Please bring any erros to the attention of the Engineer's Office staff. Thank you